

# SAMUEL HEATH

**Product Number:** V135-IS

**Description:** 1/2" Concealed thermostatic valve - rough

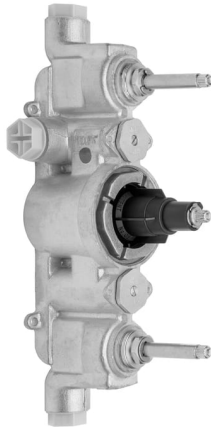

## Standards



## Flow rates

| Litres/Min | 0.1 Bar | 0.5 Bar | 1.0 Bar | 2.0 Bar | 3.0 Bar | 4.0 Bar | 5.0 Bar |
|------------|---------|---------|---------|---------|---------|---------|---------|
| 1/2" Feed  |         | 11.8    | 17.2    | 26.6    | 32.0    | 36.0    | 40.5    |
| 3/4" Feed  |         | 11.8    | 17.2    | 26.6    | 32.0    | 36.0    | 40.5    |

Flow rate data provided is indicative of each product and is given in open outlet conditions. Installation design, external connections and fittings not supplied may affect the data provided.

## Specification Drawing

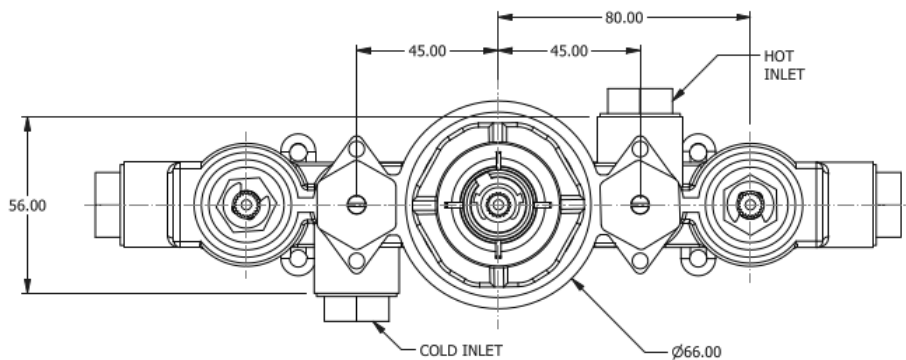

| TRIM    | DIMENSION A RANGE |
|---------|-------------------|
| V102-T  | 71.80 TO 106.70   |
| V202-T  | 73.00 TO 84.30    |
| V602-T  | 71.80 TO 82.80    |
| V702-T  | 110.00 TO 119.00  |
| V802-T  | 87.00 TO 98.00    |
| T1002-T | 109.00 TO 120.00  |
| T2002-T | 120.00 TO 131.00  |

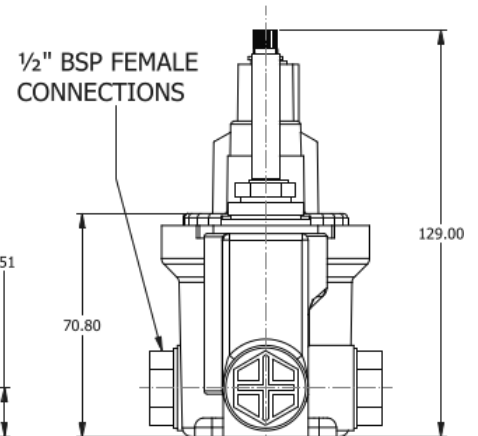
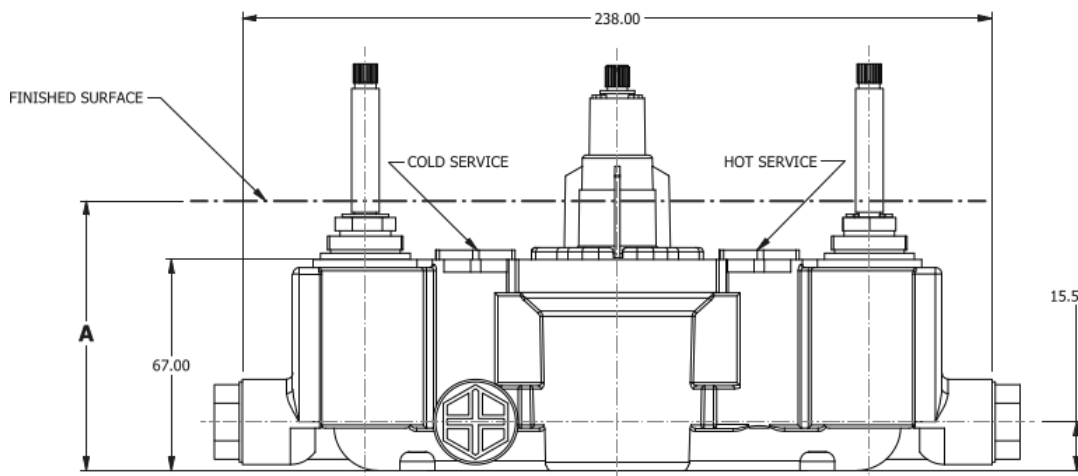

### UK Customer Service

Leopold Street  
Birmingham  
B12 0UJ  
Tel: +44 121 766 4200  
Email: info@samuel-heath.com

### US Customer Service

Federal I.D. No. 58-1504682  
Email: usa@samuel-heath.com

### Specification Enquiries

Design Centre Chelsea Harbour  
1st Floor, North Dome, London  
SW10 0XE  
Tel: 020 7352 0249  
Email: showroom@samuel-heath.com

1-20/11/2024